

## GGX50 AST Grease Guardian Installation Details

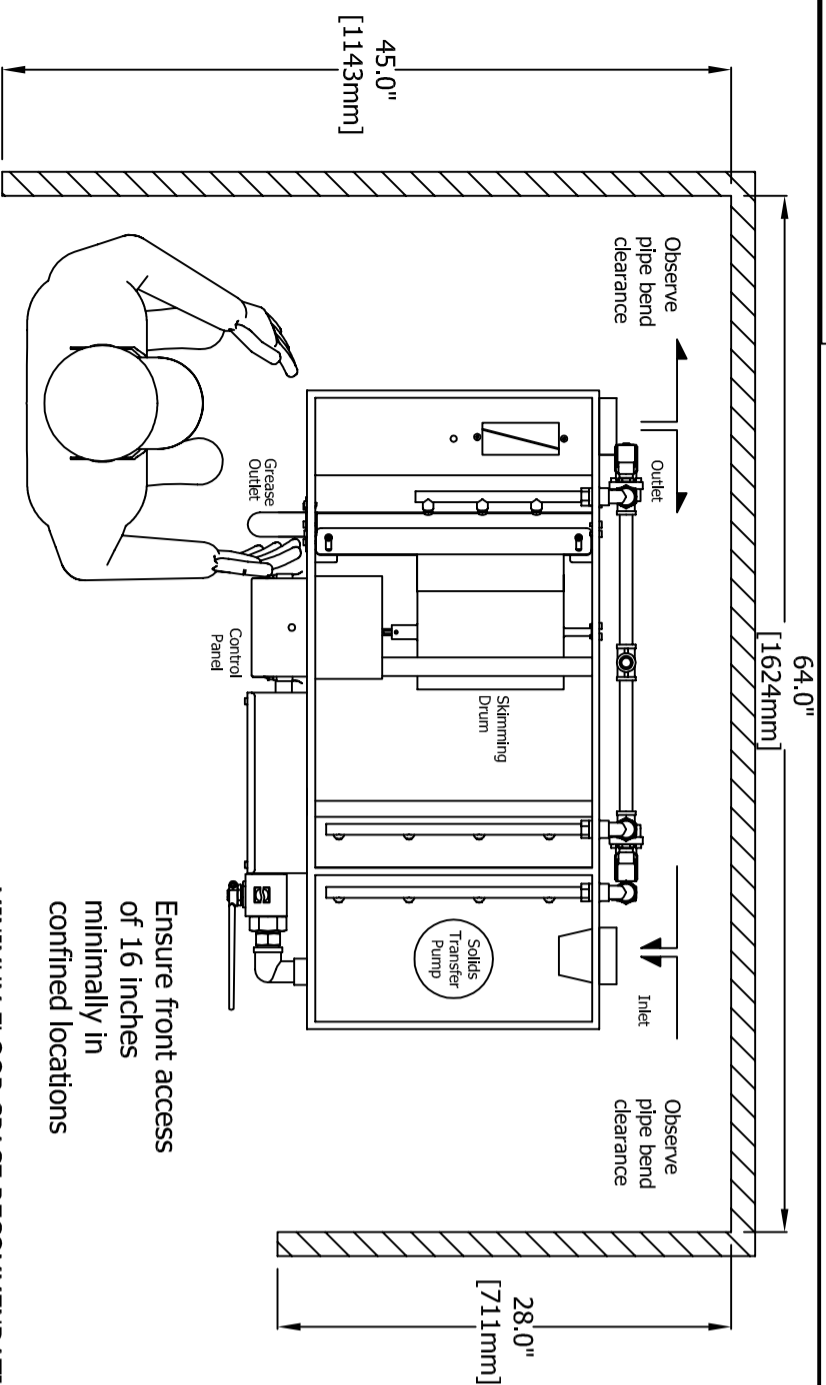

### KEY INSTALLATION NOTES:

This unit is to be installed free standing normally at a lower level than the kitchen floor.  
 Allow for the minimum dimensions shown.  
 Keep outlet piping at a fall of  $\frac{1}{8}$ " per foot (1:40).  
 Use adjustable rubber pipe connectors as supplied.  
 Only switch on after filling system to the required level  
 Refer to manual for full installation details.

### SPECIFICATION:

**Grease Guardian Model GGX50 AST:**  
 Self cleaning automatic grease removal unit, 16 gauge fully welded 304 stainless steel tank, stainless steel internal baffle plate, fully sealed air tight stainless steel lid and robust stainless steel clamps, stainless steel solids strainer mesh plate, easy fit pipe couplings supplied, 50 gallons per minute flowrate, and skimming rate of 20 pounds per hour.  
 The GGX50 AST is supplied with an automatic solids transfer (AST) pump with integral automatic screen wash system, rotating grease skimming drum with automatic internal wash system, automatic wash for scum dispersion, integral gas trap, totally enclosed geared drive unit, 600 watt immersion heater with self regulating safety control, programmable controller with interface, energy saving mode and visual alerts. The GGX50 AST is suitable for floor and shelf type mounting; 3 year warranty as standard.

### Electrical Details

GGX50AST 110Vac, 1062 Watts, 12.7A\*

### PRE START CHECK UP:

Ensure unit is positioned on a level surface and is plumbed in securely.  
 Ensure electrical outlet is fitted with dedicated ground fault circuit breaker.  
 Ensure that the unit is filled with water to the correct level.  
 Set correct controller date and time as detailed in the manual.  
 Ensure that collection receptacle is empty and securely in place.

### GREASE GUARDIAN WORLD:

Grease Guardian World is an interactive online register of all Grease Guardian branded products uploaded and managed by Grease Guardian, distributors and end users.

Grease Guardian World allows users to:

- Upload and manage individual sites
- Monitor specification, service history, supplier details for each Grease Guardian installed
- Upload and view installation photographs
- Upload and view Operation & Maintenance manuals
- Upload and view service engineer reports
- Locate sites using Google Maps linking
- Access and manage accounts on-line
- Manage recycled fats, oils and greases (FOGs)

## GGX50 AST Grease Guardian Standard Specification

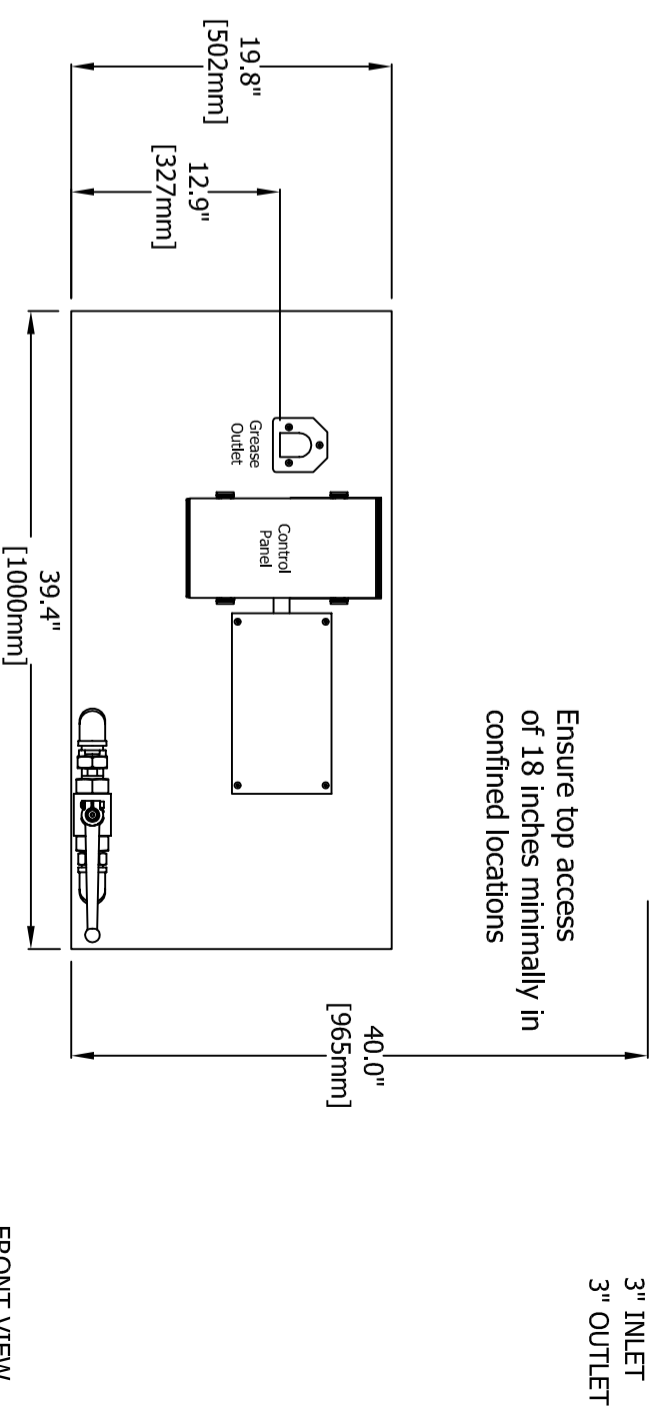

FRONT VIEW

### GREASE GUARDIAN X AST STANDARD FEATURES:

- 3 Year Guarantee
- Fully Automatic Grease Removal Unit (AGRU)
- 16 gauge 304 stainless steel welded tank
- Fully sealed air tight lid
- PLC/HMI automatic controller
- Energy saving mode
- Skimming drum with automatic spray bar wash
- Automatic wash-water conditioning system
- Automatic screen mesh spray bar wash
- Automatic Solids Transfer (AST) system
- Grease Guardian World asset management

SIDE ELEVATION

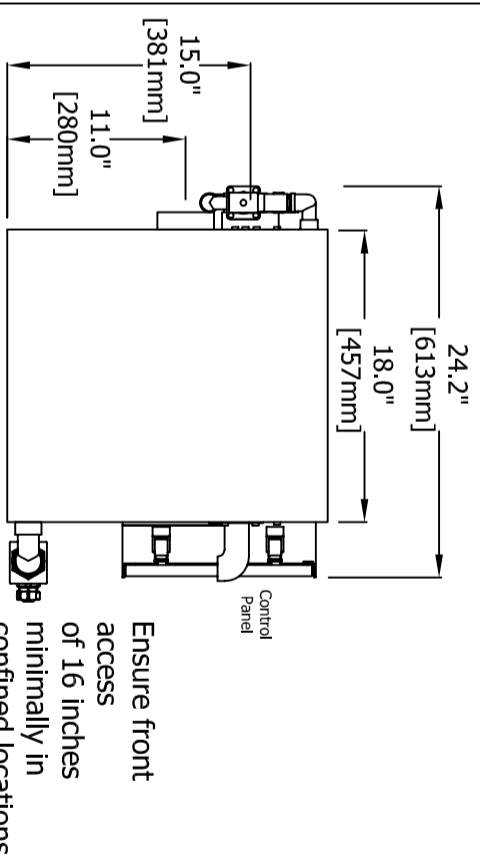

### TECHNICAL DATA

Weight \_\_\_\_\_ 220 pounds  
 Exterior Materials \_\_\_\_\_ 16 gauge AISI304 Stainless Steel  
 Interior Materials \_\_\_\_\_ AISI304 Stainless Steel & Acetal Components  
 Maximum Flow Rate \_\_\_\_\_ 50 GPM  
 Solids transfer pump rating (flow/head max) \_\_\_\_\_ 70gpm/13.5psi (16m3h/9.5m)  
 Skimming Rate \_\_\_\_\_ 20 pounds per hour  
 Grease Retention Capacity \_\_\_\_\_ 100+ pounds  
 Wash water system operation requirements (minimum) \_\_\_\_\_ 12gpm/43.5psi (0.75litres/s@3bar)  
 Programming/Control \_\_\_\_\_ 7day, 24hr multi-function PLC  
 Electrical Load \_\_\_\_\_ 110VAC, 1062W, 12.7A max\*

\* Current absorbed depends on pump discharge head