

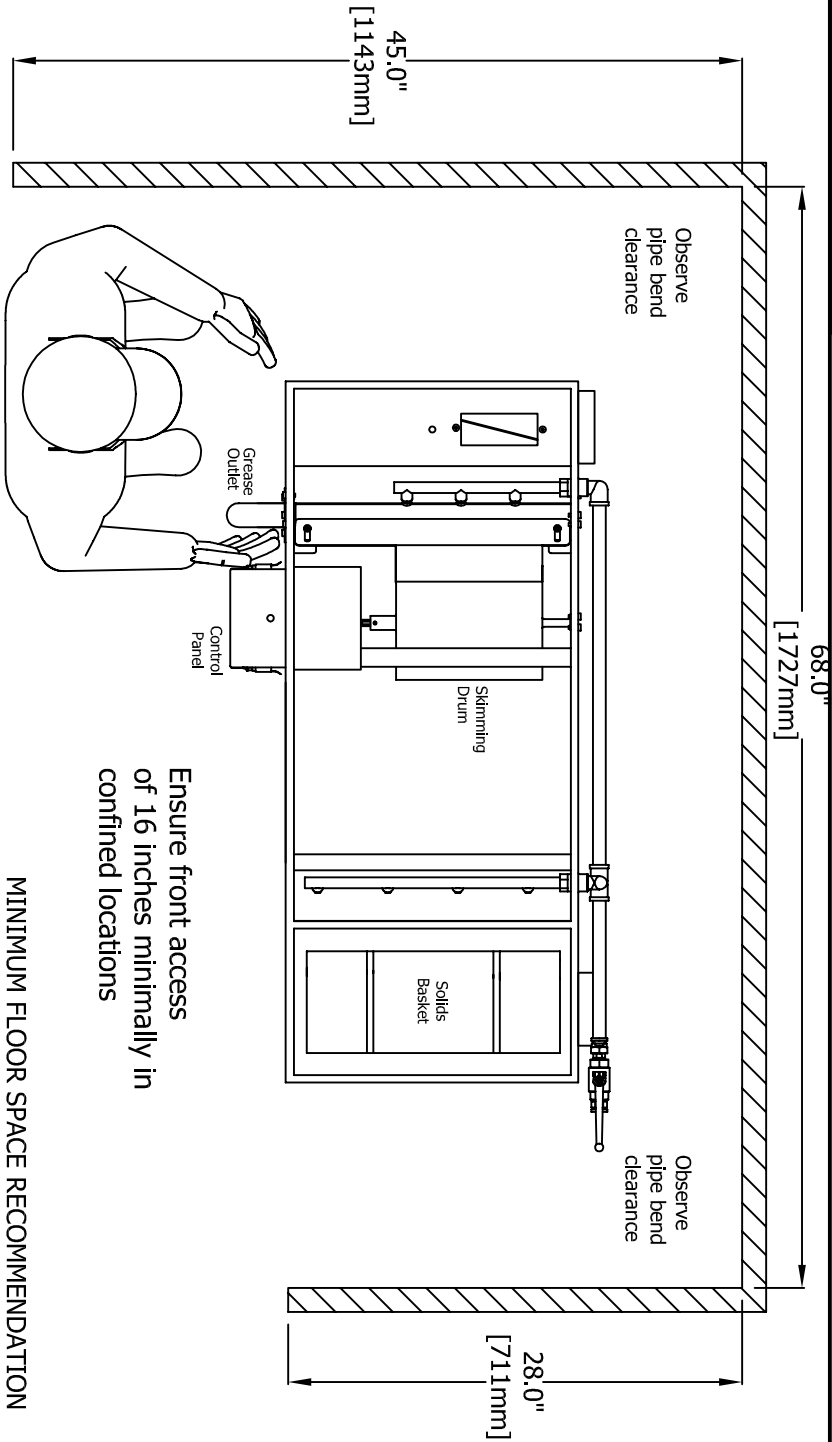

# GGX75 Grease Guardian Installation Details



### KEY INSTALLATION NOTES:

This unit is to be installed free standing normally at a lower level than the kitchen floor.  
Allow for the minimum dimensions shown.  
Keep outlet piping at a fall of  $\frac{1}{8}$  " per foot (1:40).  
Use adjustable rubber pipe connectors as supplied.  
Only switch on after filling system to the required level  
Refer to manual for full installation details.

### SPECIFICATION:

Grease Guardian Model GGX75: Automatic grease removal unit, 16 gauge fully welded 304 stainless steel tank, stainless steel internal baffle plate, fully sealed air tight stainless steel lid and robust stainless steel clamps, stainless steel vertical lift solids strainer basket for easy disposal of solids, easy fit pipe couplings supplied. 75 gallons per minute flowrate, and skimming rate of 20 pounds per hour. The GGX75 is supplied with a rotating grease skimming drum with a manually operated internal wash system for the wiper blade and scum dispersion, integral gas trap, totally enclosed geared drive unit, 600 watt immersion heater with self regulating safety control, programmable controller with interface, energy saving mode and visual alerts. The GGX75 is suitable for floor and shelf type mounting. 3 year warranty as standard.

### Electrical Details

GGX75 110VAc, 635 Watts, 5.8A

www.greaseguardianUSA.com

GGX75 rG



# GGX75 Grease Guardian Standard Specification

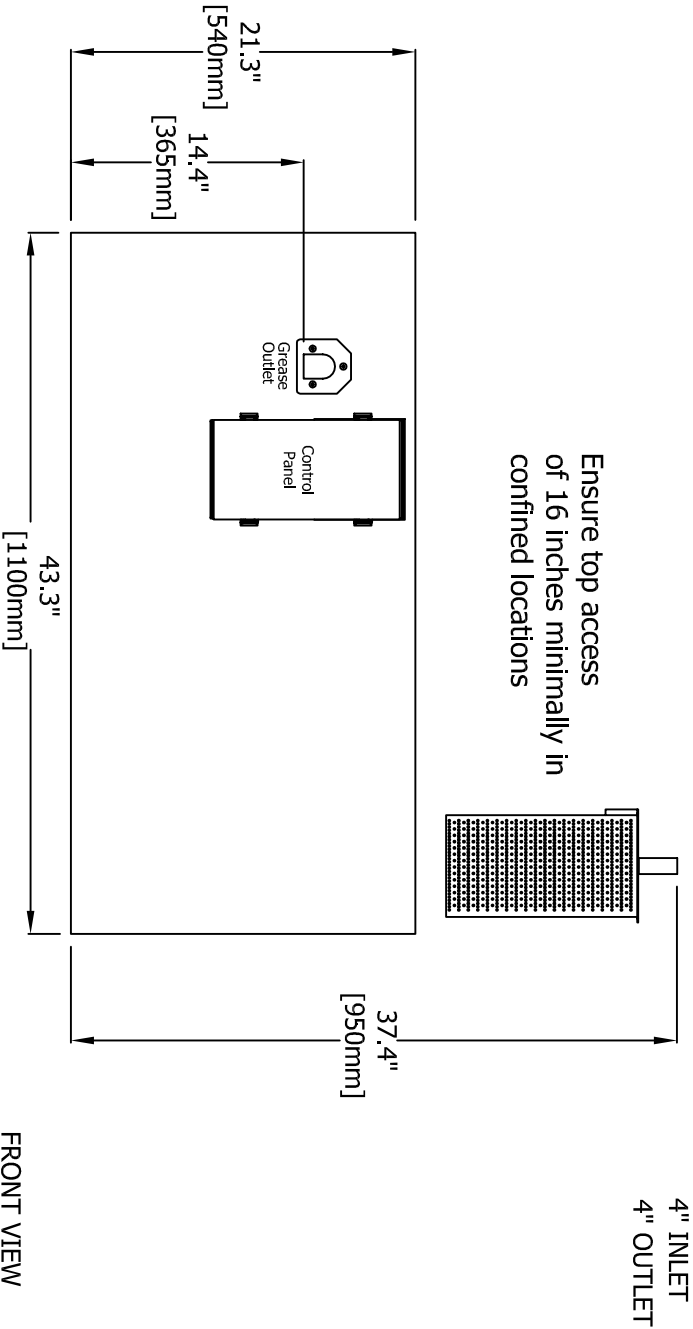

FRONT VIEW

### GREASE GUARDIAN X STANDARD FEATURES:

- 3 Year Guarantee
- Fully Automatic Grease Removal Unit (AGRU)
- 16 gauge 304 stainless steel welded tank
- Fully sealed air tight lid
- PLC/HMI automatic controller
- Energy saving mode
- Skimming drum with manual spray bar wash
- Wash-water conditioning system
- Lift-out solids basket
- Grease Guardian World asset management

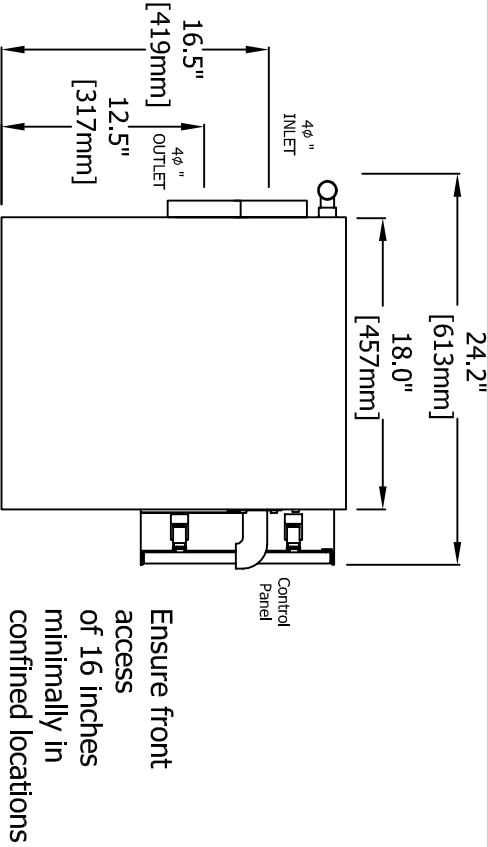

SIDE ELEVATION

### TECHNICAL DATA

Weight	210 pounds
Exterior Materials	16 gauge AISI304 Stainless Steel
Interior Materials	AISI304 Staines Steel & Acetal Components
Maximum Flow Rate	75 GPM
Lift-out screen basket capacity	2.5 gallons
Skimming Rate	20 pounds per hour
Grease Retention Capacity	150+ pounds
Wash water system operation requirements (minimum)	12gpm/43.5psi (0.75litres/s@3bar)
Programming/Control	7day, 24hr multi-function PLC
Electrical Load	110VAC, 635W, 5.8A

Copyright Jan 2015 FM Environmental Ltd. All Rights Reserved. Specification subject to change without notice

GGX75 rG